

Lap Joint Flanges - ANSI B16.5

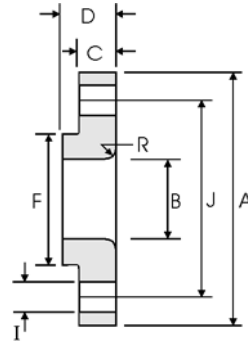

Class 150 lb

Nominal Pipe Size	Pipe	Flange Data					Lap	Hub	Drilling Data			Weight
		A	B	C	D	R	F	H	I	J		
	Outside Diameter	Overall Diameter	Inside Diameter	Flange Thickness min	Overall Length	Lap Radius	Hub Diameter	Number of Holes	Bolt Hole Diameter	Diameter of Circle of Holes	kg/ piece	
	in mm	in mm	in mm	in mm	in mm	in mm	in mm		in mm	in mm		
1/2	0.840	3.500	0.900	0.440	0.620	0.120	1.190	4	0.620	2.380	0.38	
	21.30	88.90	22.90	11.20	15.70	3.000	30.20		15.70	60.45		
3/4	1.050	3.880	1.110	0.500	0.620	0.120	1.500	4	0.620	2.750	0.55	
	26.70	98.60	28.20	12.70	15.70	3.000	38.10		15.70	69.85		
1	1.315	4.250	1.380	0.560	0.690	0.120	1.940	4	0.620	3.120	0.76	
	33.40	108.0	35.10	14.20	17.50	3.000	49.30		15.70	79.25		
1 1/4	1.660	4.620	1.720	0.620	0.810	0.190	2.310	4	0.620	3.500	1.01	
	42.20	117.3	43.70	15.70	20.60	4.800	58.70		15.70	88.90		
1 1/2	1.900	5.000	1.970	0.690	0.880	0.250	2.560	4	0.620	3.880	1.30	
	48.30	127.0	50.00	17.50	22.40	6.400	65.00		15.70	98.60		
2	2.375	6.000	2.460	0.750	1.000	0.310	3.060	4	0.750	4.750	2.03	
	60.30	152.4	62.50	19.10	25.40	7.900	77.70		19.10	120.7		
2 1/2	2.875	7.000	2.970	0.880	1.120	0.310	3.560	4	0.750	5.500	3.25	
	73.00	177.8	75.40	22.40	28.40	7.900	90.40		19.10	139.7		
3	3.500	7.500	3.600	0.940	1.190	0.380	4.250	4	0.750	6.000	3.81	
	88.90	190.5	91.40	23.90	30.20	9.700	108.0		19.10	152.4		
3 1/2	4.000	8.500	4.100	0.940	1.250	0.380	4.810	8	0.750	7.000	4.76	
	101.6	215.9	104.1	23.90	31.75	9.700	122.2		19.10	177.8		
4	4.500	9.000	4.600	0.940	1.310	0.440	5.310	8	0.750	7.500	5.25	
	114.3	228.6	116.8	23.90	33.30	11.20	134.9		19.10	190.5		
5	5.563	10.00	5.690	0.940	1.440	0.440	6.440	8	0.880	8.500	6.02	
	141.3	254.0	114.5	23.90	36.60	11.20	163.6		22.40	215.9		
6	6.625	11.00	6.750	1.000	1.560	0.500	7.560	8	0.880	9.500	7.40	
	168.3	279.4	171.5	25.40	39.60	12.70	192.0		22.40	241.3		
8	8.625	13.50	8.750	1.120	1.750	0.500	9.690	8	0.880	11.75	12.1	
	219.1	342.9	222.3	28.40	44.50	12.70	246.1		22.40	298.5		
10	10.75	16.00	10.92	1.190	1.940	0.500	12.00	12	1.000	14.25	16.4	
	273.0	406.4	277.4	30.20	49.30	12.70	304.8		25.40	362.0		
12	12.75	19.00	12.92	1.250	2.190	0.500	14.38	12	1.000	17.00	26.1	
	323.8	482.6	328.2	31.75	55.60	12.70	365.3		25.40	431.8		
14	14.00	21.00	14.18	1.380	3.120	0.500	15.75	12	1.120	18.75	34.5	
	355.6	533.4	360.2	35.10	79.25	12.70	400.1		28.40	476.3		
16	16.00	23.50	16.19	1.440	3.440	0.500	18.00	16	1.120	21.25	44.6	
	406.4	596.9	411.2	36.60	87.40	12.70	457.2		28.40	539.8		
18	18.00	25.00	18.20	1.560	3.810	0.500	19.88	16	1.250	22.75	48.7	
	457.2	635.0	462.3	39.60	96.80	12.70	505.0		31.75	577.9		
20	20.00	27.50	20.25	1.690	4.060	0.500	22.00	20	1.250	25.00	61.6	
	508.0	698.5	514.4	42.90	103.1	12.70	558.8		31.75	635.0		
24	24.00	32.00	24.25	1.880	4.380	0.500	26.12	20	1.380	29.50	86.6	
	609.6	812.8	616.0	47.80	111.3	12.70	663.4		35.10	749.3		

Notes

- Weights are based on manufacturer's data and are approximate.